



18 North Hirne Court, King's Lynn PE30 1LT

£132,500

2 1 1



NO ONWARD CHAIN! Are you seeking town centre living with your very own parking space? This wonderful, ground floor apartment, boasts a comfortable level of bright and airy, well proportioned accommodation that is ready to be enjoyed from the moment you turn the key in the door.





Key Features

- Ground Floor Flat
- No Onward Chain
- 24ft Living/Dining Room
- Long Lease - Over 900 Years Remaining
- Communal Gardens and Store
- Two Double Bedrooms
- Close to town centre
- Well Presented Throughout
- Allocated Parking Space
- Walking Distance to a Wealth of Amenities

GROUND FLOOR
569 sq.ft. (52.9 sq.m.) approx.

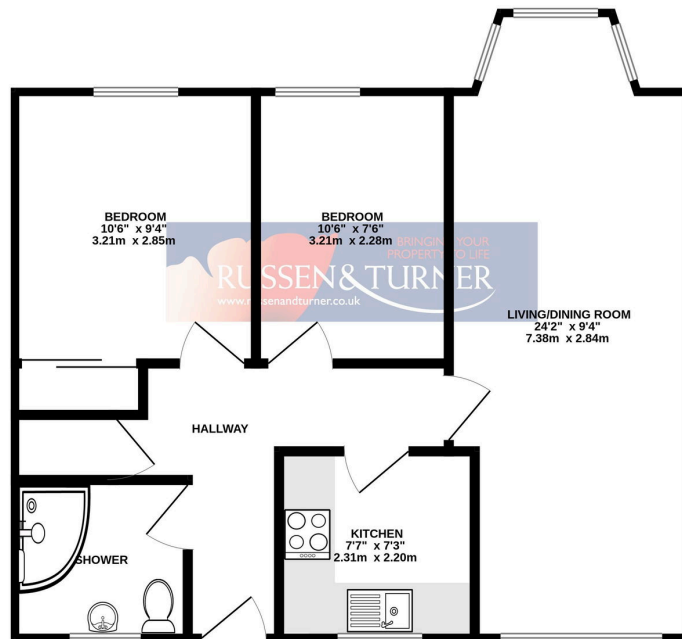

TOTAL FLOOR AREA: 569 sq.ft. (52.9 sq.m.) approx.

Whilst every attempt has been made to ensure the accuracy of the floorplan contained here, measurements of doors, windows, rooms and any other items are approximate and no responsibility is taken for any error, omission or misstatement. This plan is for illustrative purposes only and should be used as such by any prospective purchaser. The services, systems and appliances shown have not been tested and no guarantee as to their operability or efficiency can be given.
Made with Metropix ©2024

